



TREE-D PANELS
Sustainable Wood Textured Wall Panels

www.treedpanels.com

INSTALLATIONS

Recommended Forms of Easy Installation

Always ensure walls or areas of attachment are plumb & level prior install

1	Direct Screw Attachment	Unfinished Panels
2	Mitering Corners	Unfinished Panels
3	French Cleat (Wood)	Unfinished or Finished Panels
4	Monarch Z-Clip Fasteners	Unfinished or Finished Panels



TREE-D PANELS
Sustainable Wood Textured Wall Panels

www.treedpanels.com

INSTALLATION METHOD # 1

Direct Screw Attachment

Unfinished Panels

Raw or **unfinished** panels may be screwed directly to the wall (studs), ensuring there is adequate support. Next, the screw holes can be puttied, sanded and then painted. We recommend an MDF primer followed by 2 coats of acrylic paint.

To achieve the best finish, sand the panels between each coat of paint and follow the paint manufacturer's instructions. Before attaching, ensure that each panel is the right way up and check that the pattern will align when they are mounted to the wall.

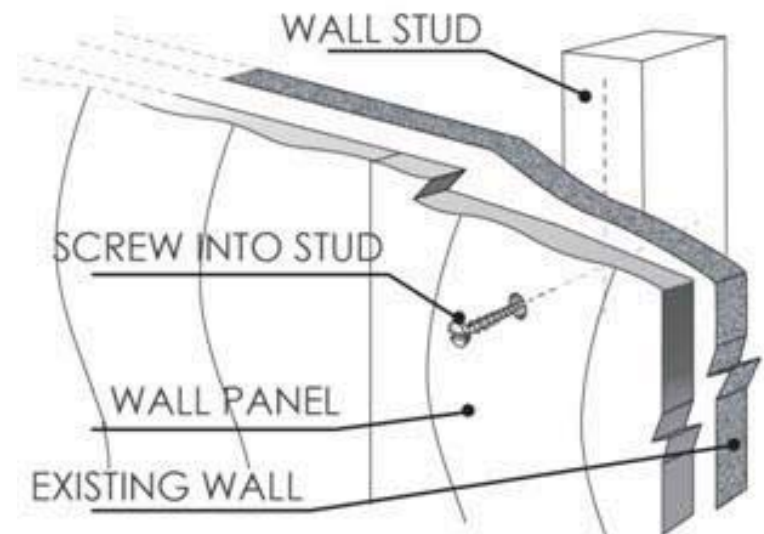



TREE-D PANELS
Sustainable Wood Textured Wall Panels

www.treedpanels.com

INSTALLATION METHOD #2

Mitering Corners

External corners may be created by cutting and mitering the panels, however it must be noted that approximately 1/8" of the design is lost in the cutting process. Therefore the pattern may not necessarily align when the edges are put together.

For easier treatment of external corners, an aluminium square or angle can be fitted on the corner. An added advantage is the protection of the panel edges. Similarly for internal corners, an aluminium square can be used so that the panels are butted up against it on either side.

If internal corner mitering is preferred, it must be noted that approximately 1-1/2" of the pattern will be lost in the cutting process, so if pattern alignment is preferred, then panels should be cut from full sized panels starting from the corner and mounting outwards.

Any exposed edges of panels may be fitted into an aluminium angle to minimize the possible damage

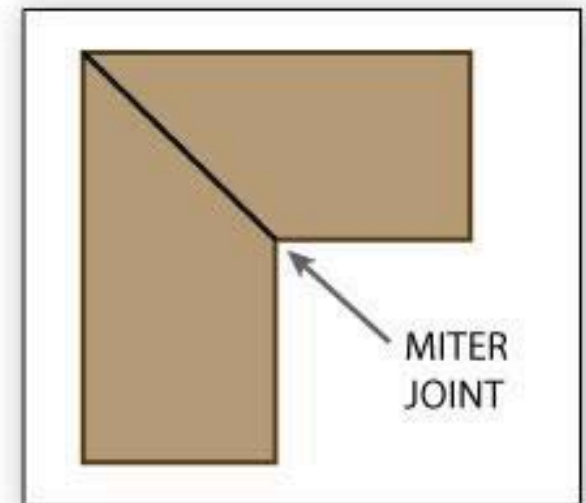



TREE-D PANELS
Sustainable Wood Textured Wall Panels

www.treedpanels.com

INSTALLATION METHOD #3

French Cleat – Wood: *Concealed Installation of Unfinished & Finished Panels*

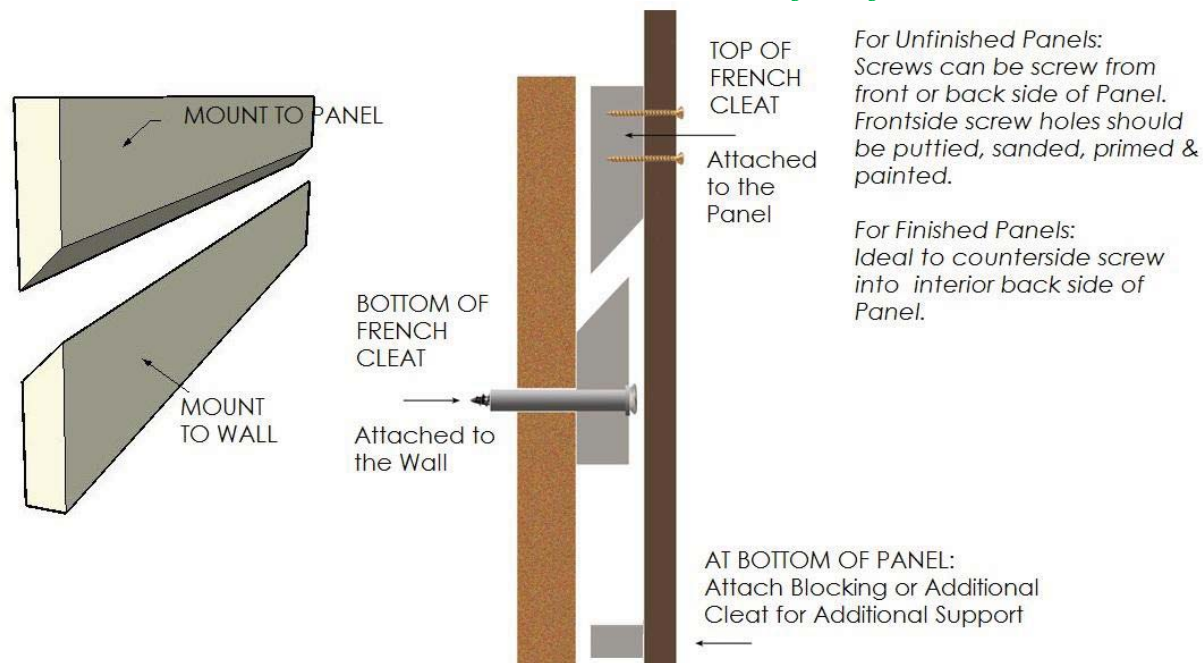

French Cleat consists of two pieces of wood, each with a bevel cut on one edge where one piece is mounted to the wall (secured to the studs) and the other piece is mounted to the back of the item being hung on the wall. One piece will be mounted to the back of the panel to be hung. The piece will be oriented so that the angle faces down and the longer part of the angle faces out. The other piece will be mounted to the wall and secured to the studs with the angle facing up, and the longer edge of the angle facing out. Ensure both pieces are level and straight! To hang the heavy item, "stack" the cleat on the item being hung over the cleat mounted to the wall. The panel should be now securely hung on the wall.



TREE-D PANELS
Sustainable Wood Textured Wall Panels

www.treedpanels.com

INSTALLATION METHOD #4

Monarch Z-Clip Fasteners: *Concealed Installation of Unfinished & Finished Panels*

Part 1 of 3: Z-Clip Instructions – Basic Connection

For concealed installation of **finished** panels to leveled walls, aluminum Z hanging brackets provide:

- Low profile install with a shallow gap between wall & wall panels
- Lightweight and strong
- Easily removable

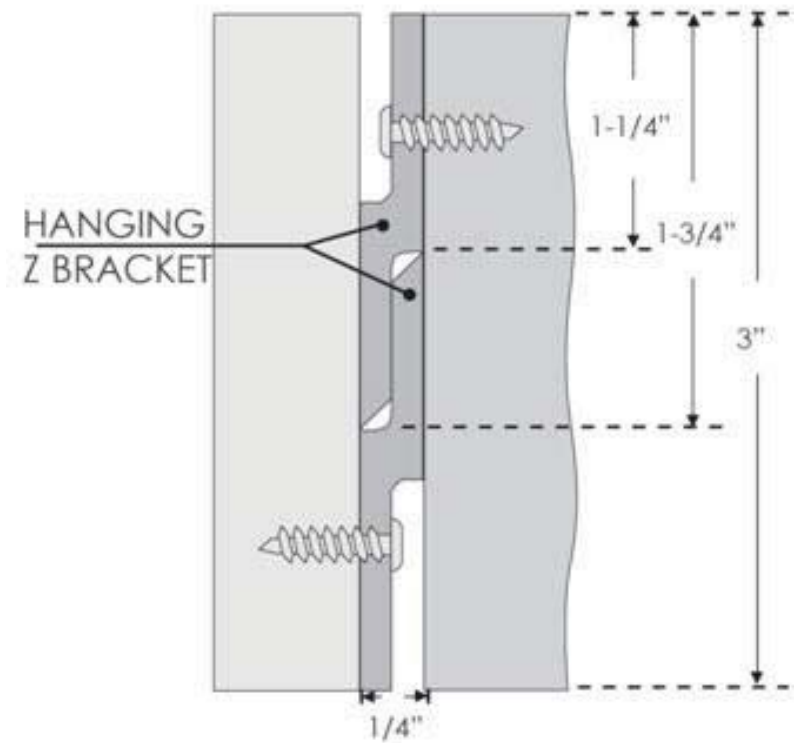



TREE-D PANELS
Sustainable Wood Textured Wall Panels

www.treedpanels.com

INSTALLATION METHOD #4

Monarch Z-Clip Fasteners: *Concealed Installation of Unfinished & Finished Panels*

Part 2 of 3: Z-Clip Instructions – Connection between Adjacent Finished Panels

The connection between wall panels can be completed through different methods: butt joined, biscuit joined or mounted with a negative detail (with a space between the panels).

Note: As the panels are of differing thickness over the patterned surface, always use screws that are of the appropriate length so that when screwing Z brackets to the panels from the rear, the screws won't go through the patterned surface.

A suggested method of fixing butt joined wall panels to a wall follows.

Z brackets for each wall panel can be fixed to the back of the wall panels at the left and right hand sides at the top, middle and bottom with appropriate length screws and adhesive.

Using screws of the appropriate length, (wall screws will be much longer than panel screws) screw full lengths of Z brackets to the walls so that the entire wall has full lengths running across it at the top, middle and bottom. The position of the Z brackets on the wall are to be offset by the width of the Z brackets on the panels.

Allow at least a 7" gap from the ceiling to the top of the panel to allow the panel mounted bracket to be slid over the top of and into the wall mounted bracket. The panel will be locked into place when the panel mounted bracket is slid all the way into the wall mounted bracket.

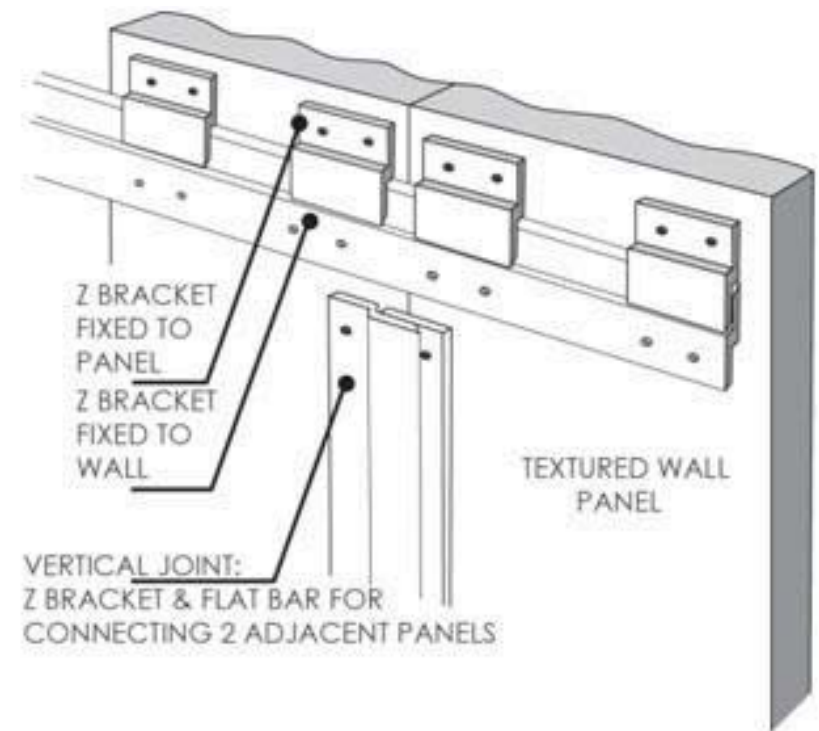



TREE-D PANELS
Sustainable Wood Textured Wall Panels

www.treedpanels.com

INSTALLATION METHOD #4

Monarch Z-Clip Fasteners: *Concealed Installation of Unfinished & Finished Panels*

Part 3 of 3: Z-Clip Instructions – Vertically Connecting Adjacent Panels

To align the panel edges snugly against each other, the following is suggested:

Z Bracket Installed on Panel A

Cut 2 pieces of 36-48" lengths of Z brackets, which shall be vertically installed along the edge of Panel A.

Flat Bar Installed on Panel B

Cut 2 pieces of 36-48" lengths of flat bar, which shall be vertically installed along the edge of Panel B. Make sure that flat bar will fit snugly into the adjoining Panel A Z Bracket depression. The flat bar edge on Panel B should protrude beyond the finished the finished edge to click into Panel A hardware.

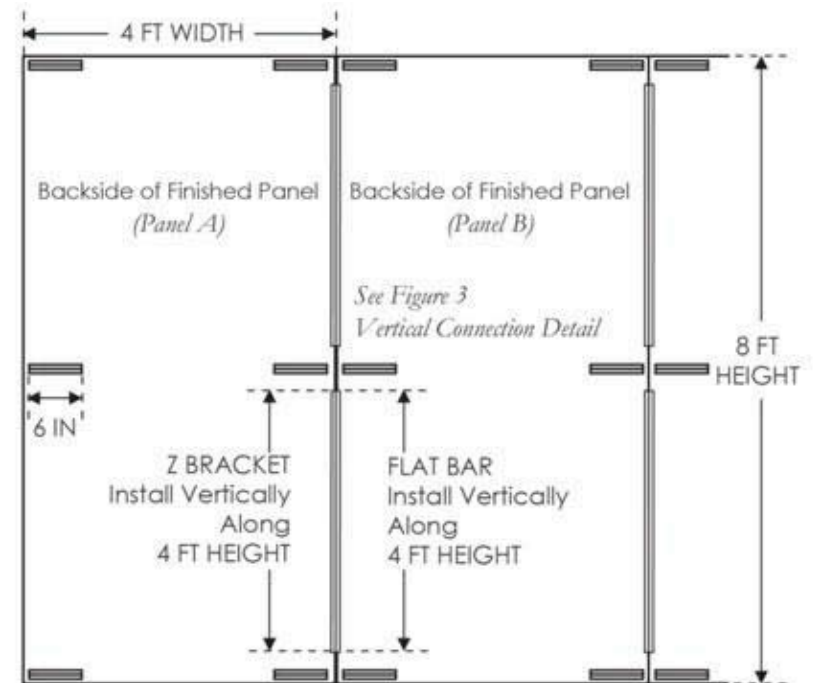

Further attachment is suggested with a silicone based epoxy.



TREE-D PANELS
Sustainable Wood Textured Wall Panels

www.treedpanels.com

STORAGE

In order to preserve the quality & condition of your product once received, please follow the below required storage conditions prior installation of product:

STORE:

- In Covered, Dry, Enclosed Area
- Avoid Direct Heat or Sunlight
- Avoid Contact with Liquids
- Store Flat on Pallette until Install
- Do Not Place Heavy Objects on Top of Panel